

## PRODUCT INFO

### PANNIER STABILIZING INSERT

Insert for stabilizing Back-Roller, Bike-Packer and -Shopper

PVC  
free

NYLON

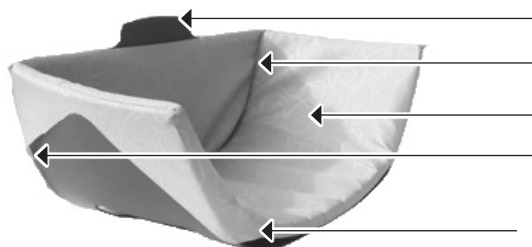

Tab for fixing in internal stiffener

Insert made of bright material for better visibility of the contents

easy to insert and remove

Foldable by folding out the corner for easy storage when the bag or insert is

soft padding

Interior panels with mounting option (from 2024):

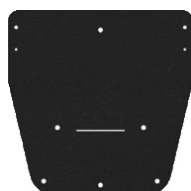

Interior stiffening QL2.1 bags

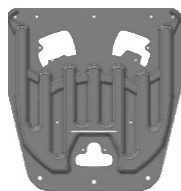

Interior stiffening QL3.1 bags

Retrofit kit for QL1, QL2 and QL2.1 pockets without prepared internal stiffener (2023 or earlier):



Retrofit Kit for Pannier Stabilizing Insert (F3912)

Note: QL3.1 bags before 2024 can be retrofitted through Customerservice

### SPECIFICATIONS:

- + Bag contents are even better secured due to additional padding
- + bright nylon fabric allows better recognition of the bag contents
- + easy to insert and remove
- + Collapsible for easy storage when not in use
- + ideal for commuters
- + Stable, even when empty
- + Access to existing inner pocket of the wheel bag possible
- + Inner pocket of bike pannier still accessible
- + Suitable for all Back-Roller, Bike-Packer and Bike-Shopper from 2024
- + For QL2.1 reuse T15 screws from the lower rail to mount F3912 Retrofit Kit
- + For QL1 and QL2 reuse screws and screwnuts from the lower rail to mount F3912 Retrofit Kit

**Contents:** Pannier Stabilizing Insert

**Note:** Not waterproof

**Separately available accessories:** Retrofit Kit for Pannier Stabilizing Insert (F3912)

